

HILL HOLDER

The hill holder, available on cars equipped with a clutch pedal, will operate if the brakes are applied while the clutch is depressed and the car is stopped on an upgrade. The hill holder under these conditions will retain the same amount of pressure in the brake lines as was used in stopping the car and is not released until the clutch pedal is released. This permits the operator to use his right foot to operate the accelerator since it is not necessary to hold the brake pedal, when ready to resume forward motion.

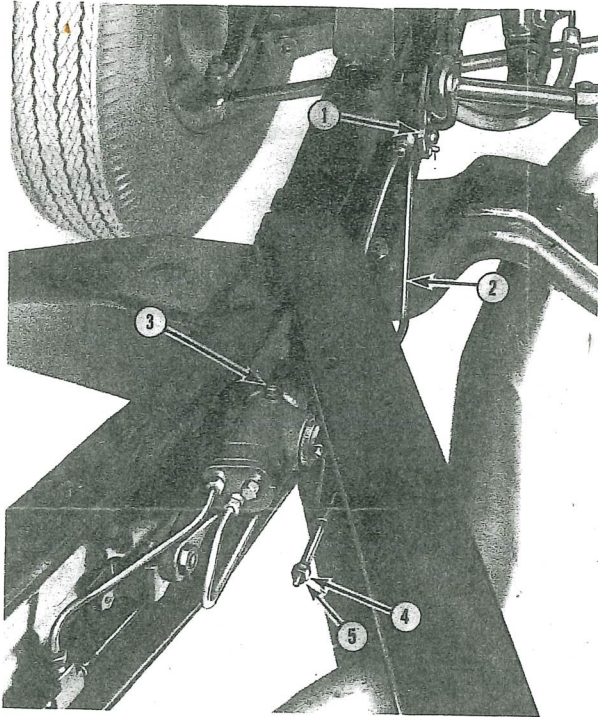

Fig. 21

- | | |
|------------------------|------------------|
| 1. Release shaft lever | 4. Locknut |
| 2. Operating rod | 5. Adjusting nut |
| 3. Bleeder screw | |

Removal

1. Disconnect the hill holder operating rod (2, Fig. 21) from the clutch release shaft lever (1).
2. Disconnect the brake fluid lines.
3. Remove the mounting bolts and remove the hill holder and operating rod from the mounting bracket.

Installation

1. Attach the hill holder to the frame bracket with the retaining bolt and connect the end of the operating rod to the clutch operating shaft lever.
2. Connect the hydraulic lines to the hill holder and tighten the connections securely.
3. Bleed the hill holder at the bleeder screw (3), at the top of the unit.
4. Adjust the operating rod as outlined under 'Adjustment'.

Adjustment

1. To adjust the hill holder, loosen the locknut (4) on the end of the operating rod and turn the adjusting nut (5) either in or out to provide simultaneous hill holder release and clutch engagement as the clutch pedal is released.
2. Tighten the operating rod locknut after the correct adjustment is obtained.

Disassembly

1. Remove the rod from the operating lever and guide assembly.
2. Remove lever clamp screw (12, Fig. 22) and remove the lever from the camshaft (5).
3. Remove the housing end plug (11), gasket (10), and ball cage spring from the housing.
4. Remove the camshaft plug (2) and gasket (4), and take the camshaft end seal (3) out of the plug.
5. Turn the camshaft (5) to disengage the cam from the slot in the ball cage (8) and pull the camshaft out of the housing.
6. Remove the spring (6) from the end of the camshaft. Then remove the ball cage assembly from the chamber.

Servicing

The hill holder repair kit consists of the ball cage assembly, the end plug gasket, the camshaft plug gasket, and the camshaft sealing washer.

Use clean alcohol or brake fluid to wash all parts. Do not use gasoline, kerosene, or any other solvent which might introduce mineral oil into the system. Dip all parts in approved heavy-duty brake fluid before reassembly. Be very careful to keep all parts clean during reassembly.

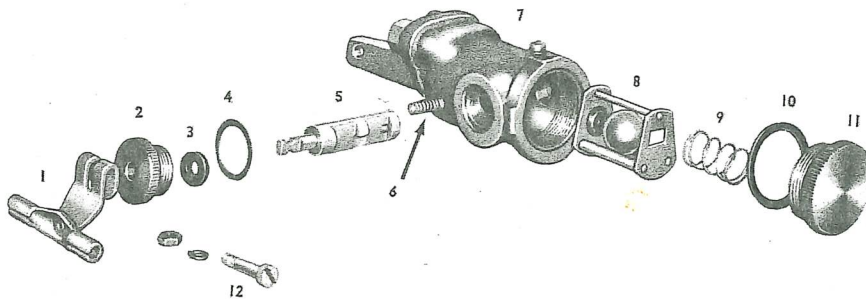

Fig. 22

- | |
|-------------------|
| 1. Guide assembly |
| 2. Shaft plug |
| 3. End seal |
| 4. Gasket |
| 5. Camshaft |
| 6. Spring |
| 7. Housing |
| 8. Ball cage |
| 9. Spring |
| 10. Gasket |
| 11. End plug |
| 12. Clamp screw |